

AIFZE - PERFORMANCE

AIFZE: a leading supplier of structural steel products for the construction industry for our excellence of service and conformance to the highest quality standards, our products are widely marketed in the Emirates and the other GCC.

Dry Wall Partition System

Stud and Track Partitioning System is a versatile lightweight, non-load bearing system and can be easily assembled at Site, Saving on time. These are very cost effective and suitable for all types of commercial, recreational, industrial and residential developments. This section allows inclusion of services during construction.

Stud and Track partitioning is fully compatible with our ceiling furring systems.

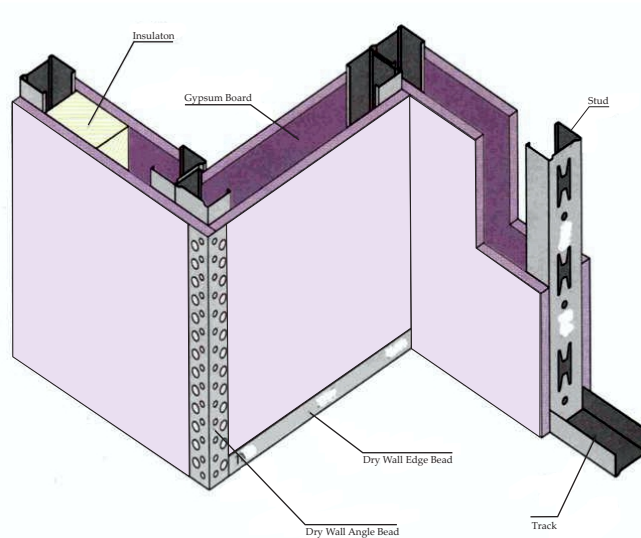

Stud

Reference	Dimension(mm)			Thickness(mm)	Length(mm)	Material
	A	B	C			
ATR 50	50	36	34	0.4 to 1.2	3000	Galvanized
ATR 70	70	36	34	0.4 to 1.2	3000	Galvanized
ATR 98	98	36	34	0.4 to 1.2	3000	Galvanized



- Other sizes also available on

Track

Reference	Dimension(mm)			Thickness(mm)	Length(mm)	Material
	A	B	C			
ATR 52	52	25	53	0.4 to 1.2	3000	Galvanized
ATR 72	72	25	23	0.4 to 1.2	3000	Galvanized
ATR 100	100	25	23	0.4 to 1.2	3000	Galvanized

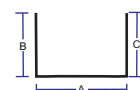

- Other sizes also available on

Ceiling Furring System

Furring Channel system comprises of a furring channel attached to the primary channel by a wire clip. The system is further supported by a perimeter angle and the entire system is suspended by various hanging methods. It is a high performance support system for Gypsum Board, providing sound insulation and fire protection that can be used for new ceiling structures or to upgrade existing ceiling

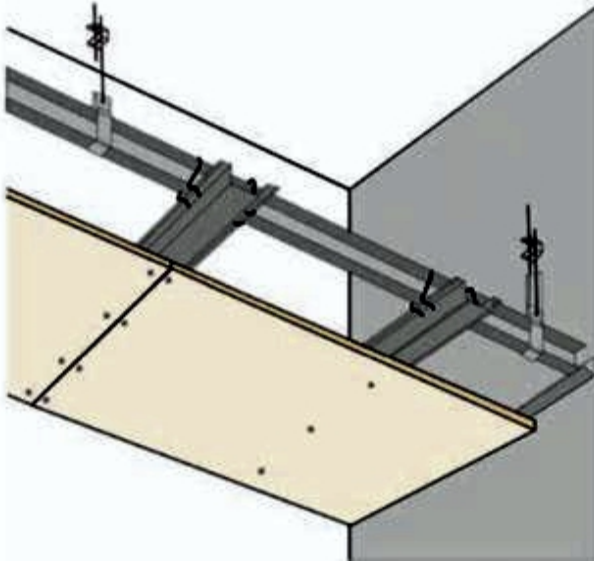

Furring system is suitable for most commercial, recreational, retail and residential building and is fully compatible with our stud and Track Partitioning system.

Furring Channel

Reference	Dimension(mm)	Thickness(mm)	Length(mm)	Material
	A B C			
ACFC35	35 22 68	0.4 to 1.2	3000	Galvanized

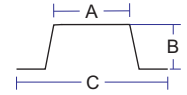

- Other sizes also available on request

Main Channel

Reference	Dimension(mm)	Thickness(mm)	Length(mm)	Material
	A B C			
ACMC38	12 38 12	0.4 to 1.2	3000	Galvanized

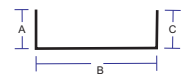

- Other sizes also available on request

Wall Angle

Reference	Dimension(mm)	Thickness(mm)	Length(mm)	Material
	A B			
ACWA25	25 25	0.4 to 1.2	3000	Galvanized
ACWA30	30 30	0.4 to 1.2	3000	Galvanized

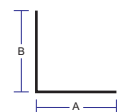

- Other sizes also available on request

Tel: +971 443122080

Fax: +97144312022

WhatsApp: +971 55 278 1803

Email: info@ahcgrp.com.af

P.O.BOX: 184020

Address: Dubai, Jebel Ali near to gate #12 Industrial Area, Warehouse #23

www.ahcgrp.com.af